

# **RECOMMENDED SCREW END-MACHINING**

## RECOMMENDED SCREW END-MACHINING

### Recommended screw end-machining (A type)

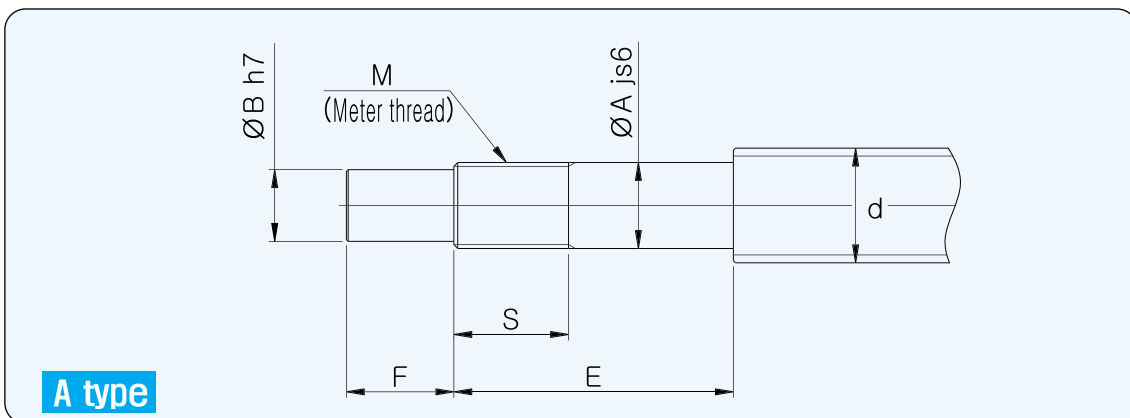

Unit:mm

Support Unit		Screw outer diameter d	Bearing outer diameter A	B	E	F	Meter thread	
Model	Type						M	S
BK, FK	8	12	8	6	34	10	M8x1	10
BK, FK	10	14	10	8	39	15	M10x1	12
BK, FK	12	15	12	10	39	15	M12x1	12
		16	12	10	39	15	M12x1	12
		18	12	10	39	15	M12x1	12
BK, FK	15	20	15	15	41	20	M15x1	12
		22	15	15	41	20	M15x1	12
		25	15	15	41	20	M15x1	12
BK	17	25	17	15	53	27	M17x1	14
BK, FK	20	28	20	17	53	27	M20x1	14
		30	20	17	53	27	M20x1	14
BK, FK	25	32	25	20	65	36	M25x1.5	18
		36	25	20	65	36	M25x1.5	18
BK, FK	30	40	30	25	72	42	M30x1.5	24
BK, FK	35	45	35	30	83	58	M35x1.5	28
BK, FK	40	50	40	35	98	70	M40x1.5	35
		55	40	35	98	70	M40x1.5	35

## Recommended screw end-machining (Btype)

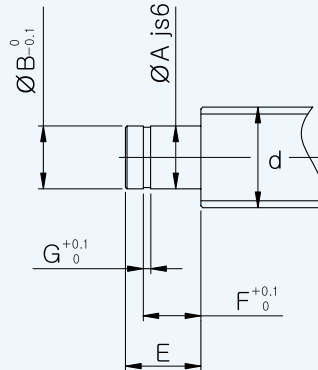

**B type**

Unit:mm

Support Unit		Screw outer diameter d	Bearing outer diameter A	E	Snap ring flute		
Model	Type				B	F	G
FF, BF	8	12	6	9	5.7	6.8	0.8
FF, BF	10	14	8	11	7.6	7.9	0.9
FF, BF	12	15	8	12	9.6	9.15	1.15
		16	10	12	9.6	9.15	1.15
		18	10	12	9.6	9.15	1.15
FF, BF	15	20	15	12	14.3	10.15	1.15
		22	15	12	14.3	10.15	1.15
		25	15	12	14.3	10.15	1.15
BF	17	25	17	16	16.2	13.35	1.15
FF, BF	20	28	20	16	19	15.35*	1.35
		30	20	16	19	15.35*	1.35
FF, BF	25	32	25	20	23.9	16.35	1.35
		36	25	20	23.9	16.35	1.35
FF, BF	30	40	30	20	28.6	17.75	1.75
FF, BF	35	45	35	25	33	18.75	1.75
BK, FK	40	50	40	25	38	19.75	1.75
		55	40	25	38	19.75	1.75

\* BF : 13.35